

NOTE: FINISH SHALL BE A STANDARD COLOR POLYESTER POWDER COAT FINISH.

HUNTINGTON SERIES			
POLE SHAFT O.D.	BASE COVER A (TOP I.D.)	B (HEIGHT)	C (BOTTOM O.D.)
2.75"	3.00"	15.75"	11.25"
4.75"	5.00"	27.00"	18.00"
7.75"	8.00"	36.50"	24.50"

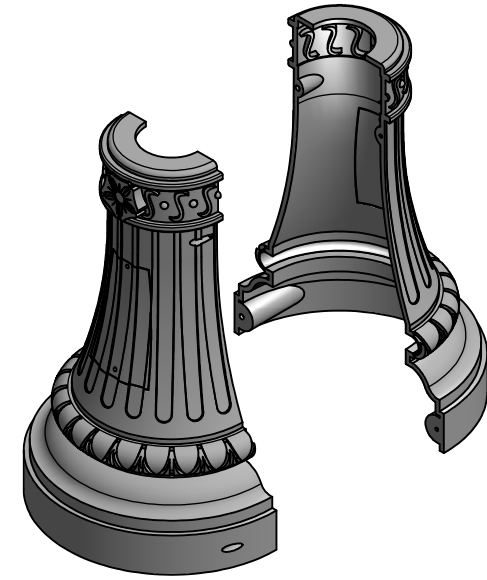
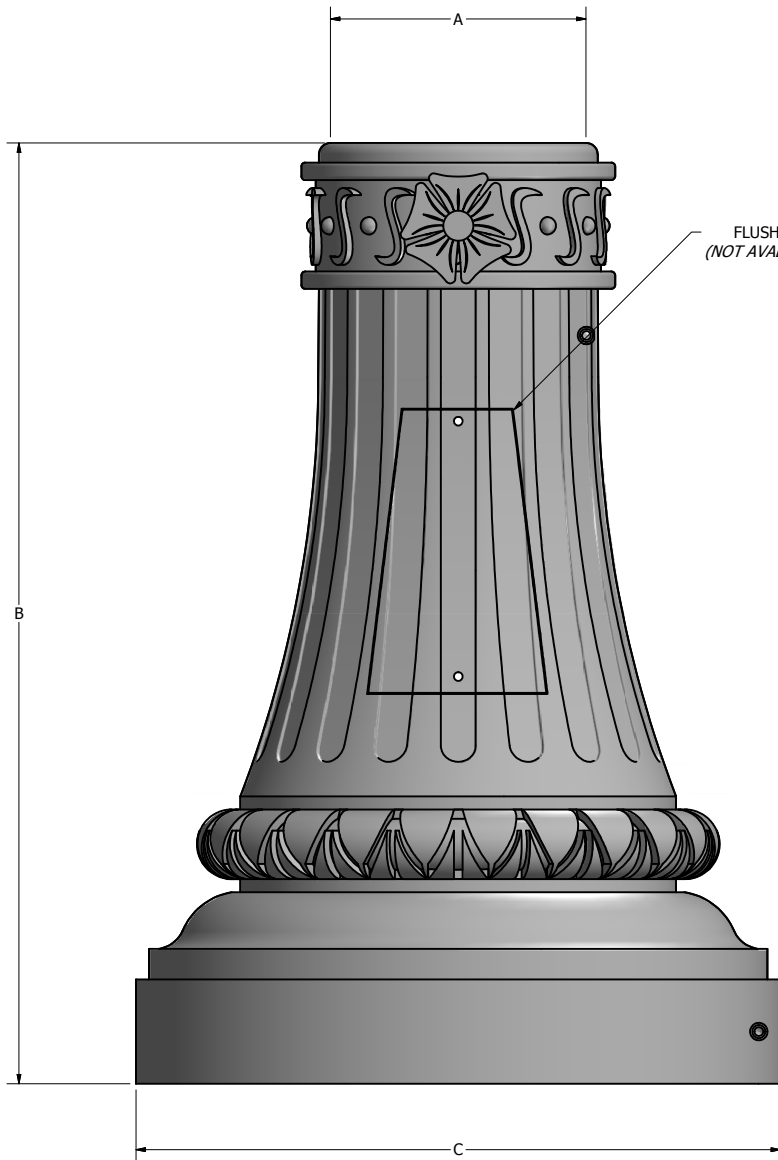

CLAMSHELL BASE COVER

UPBC-HUNT-## ##-###RD
 BOTTOM O.D. HEIGHT POLE SHAFT O.D.

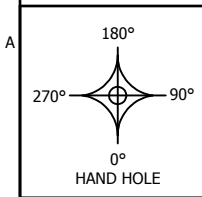

DRAWN: L. GRUNIS	12/12/2016
CHECKED:	
REVISION:	DATE:
APPROVED:	
QUOTE:	
S.O.#	
REF:	SCALE: NONE



23171 GROESBECK HWY
 WARREN, MI 48089
 (586) 774-5750
 www.unipostsystems.com

SOME GEOGRAPHICAL AREAS HAVE SPECIAL WIND CONDITIONS THAT CAN CREATE WIND INDUCED VIBRATIONS CAUSING A FATIGUE PROBLEM. NO METHOD HAS YET BEEN FOUND FOR PREDICTING DESTRUCTIVE LIGHTING POLE VIBRATION. THESE CONDITIONS ARE UNIQUE AND CANNOT BE GUARANTEED AGAINST, AND ARE THE RESPONSIBILITY OF A LOCAL SITE ENGINEER.		
TITLE: HUNTINGTON BASE COVER FOR ROUND POLES		
CATALOG:		
DWG NO: UPBC-HUNT-###-###RD	SIZE: C	SHEET 1 OF 1